

## INSTALLATION

### 1. INSTALL FRONT BUMPER EXTENSION

Install the front bumper extension with the 4 nuts.

**Torque: 5.0 N·m (50 kgf·cm, 43 in.-lbf)**

### 2. INSTALL FRONT FENDER LINER

### 3. INSTALL FRONT WHEEL OPENING EXTENSION

- (a) Install the front wheel opening extension retainer with the bolt.

**Torque: 5.0 N·m (50 kgf·cm, 43 in.-lbf)**

- (b) Using a riveter, install 2 new rivets and front wheel opening extension.

#### HINT:

- Install them with the rivet firmly pressed perpendicularly against the installation hole.
- When installing new rivets, use ones of proper part numbers.

Front side: 53888-35010

Rear side: 90269-04047

- (c) Tighten the 5 bolts.

### 4. INSTALL FRONT MUDGUARD

### 5. INSTALL FRONT WHEEL

### 6. w/ Cladding panel:

#### INSTALL FRONT DOOR OUTSIDE MOULDING

- (a) Clean the body moulding surface.
- (1) Using a heat light, heat the body moulding surface to 40 - 60 °C (104 - 140 °F).
  - (2) Remove the adhesive tape from the body.
  - (3) Wipe off the stain with cleaner.
- (b) If reusing the moulding:
- Clean the front door outside moulding.
- (1) Using a heat light, heat the moulding to 20 - 30 °C (68 - 86 °F).

#### NOTICE:

**Do not heat the moulding excessively.**

- (2) Remove the adhesive tape from the moulding.
- (3) Wipe off the stains with cleaner.

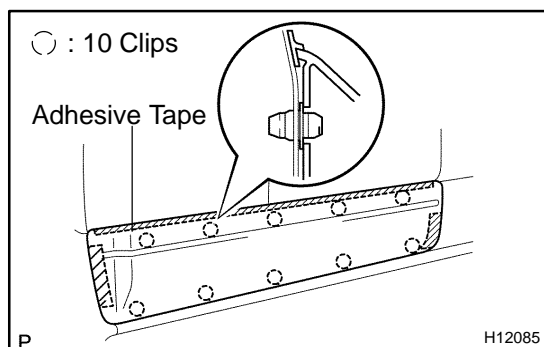

- (4) Apply new adhesive tapes to the moulding as shown in the illustration.

- (c) Install the front door outside moulding.

- (1) Using a heat light, heat the body and moulding.

**Body: 40 - 60 °C (104 - 140 °F)**

**Moulding: 20 - 30 °C (68 - 86 °F)**

#### NOTICE:

**Do not heat the moulding excessively.**

- (2) Lift the moulding release sheet from face of moulding.

**NOTICE:**

**When the moulding release sheet is removed, make sure that no dirt or dust can get onto the uncoated area.**

- (3) Align the bosses with their corresponding holes in the body, and press firmly on the moulding.

**NOTICE:**

**Do not apply excessive force onto the moulding, but steady pressure with your thumbs.**

- (4) Torque the nut.

**Torque: 5.0 N·m (50 kgf·cm, 43 in.-lbf)**

**7. w/ Cladding panel:****INSTALL REAR DOOR OUTSIDE MOULDING**

- (a) Clean the body mounting surface.
  - (1) Using a heat light, heat the body moulding surface to 40 - 60 °C (104 - 140 °F).
  - (2) Remove the adhesive tape from the body.
  - (3) Wipe off the stain with cleaner.
- (b) If reusing the moulding:
  - Clean the front door outside moulding.
  - (1) Using a heat light, heat the moulding to 20 - 30 °C (68 - 86 °F).

**NOTICE:**

**Do not heat the moulding excessively.**

- (2) Remove the adhesive tape from the moulding.
- (3) Wipe off the stains with cleaner.

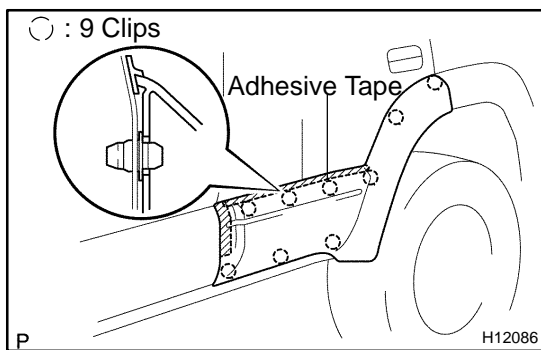

- (4) Apply new adhesive tapes to the moulding as shown in the illustration.
  - (c) Install the quarter opening retainer with the 4 bolts.
  - (d) Install the rear door outside moulding.
    - (1) Using a heat light, heat the body and moulding.
- Body: 40 - 60 °C (104 - 140 °F)**  
**Moulding: 20 - 30 °C (68 - 86 °F)**

**NOTICE:**

**Do not heat the moulding excessively.**

- (2) Lift the moulding release sheet from face of moulding.

**NOTICE:**

**When the moulding release sheet is removed, make sure that no dirt or dust can get onto the uncoated area.**

- (3) Align the bosses with their corresponding holes in the body, and press firmly on the moulding.

**NOTICE:**

**Do not apply excessive force onto the moulding, but steady pressure with your thumbs.**

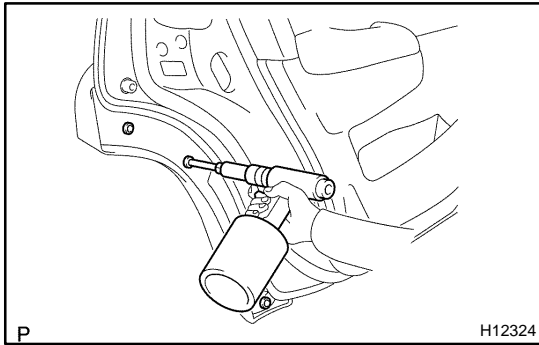

- (4) Using a riveter, install 3 new rivets and rear door outside moulding.

**HINT:**

Install them with the rivet firmly pressed perpendicularly against the installation hole.

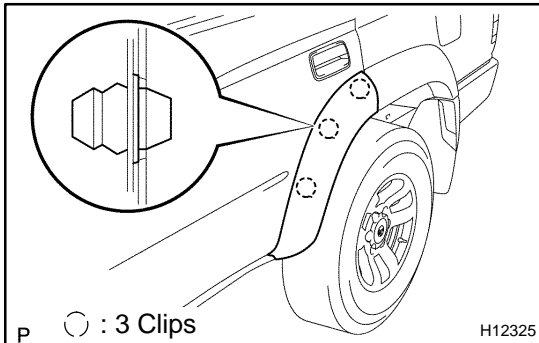
**8. w/o Cladding panel:****INSTALL REAR DOOR OUTSIDE MOULDING**

- (a) Install the quarter opening retainer with the 4 bolts.  
(b) Install the rear door outside moulding.

**HINT:**

Align the bosses with their corresponding holes in the body, and press firmly on the moulding.

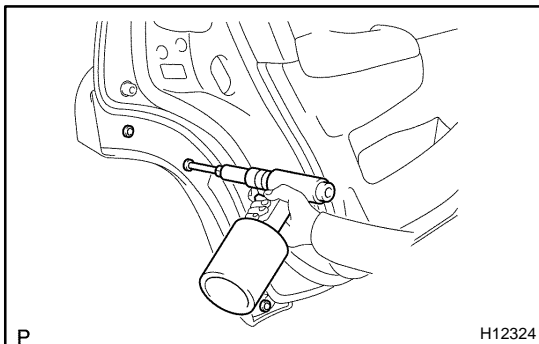

- (c) Using a riveter, install 3 new rivets and rear door outside moulding.

**HINT:**

Install them with the rivet firmly pressed perpendicularly against the installation hole.

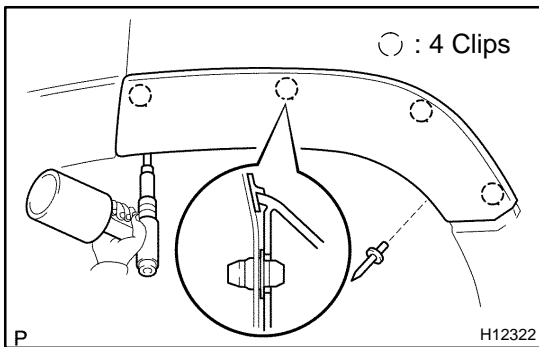
**9. INSTALL QUARTER OUTSIDE MOULDING**

- (a) Install the quarter garnish front retainer with the bolt.  
**Torque: 5.0 N·m ( 50 kgf·cm, 43 in·lbf)**  
(b) Using a riveter, install 2 new rivets and quarter outside moulding.

**HINT:**

Install them with the rivet firmly pressed perpendicularly against the installation hole.

- (c) Install the rear wheel.

**10. INSTALL ROCKER PANEL MOULDING**

- (a) Install the rocker panel moulding retainers with the 4 screws.  
(b) Install the rocker panel moulding with the 2 screws.

**HINT:**

Install them with the rivet firmly pressed perpendicularly against the installation hole.